

**CASE
HISTORY
REPORT**



INPRO/SEAL

Company name: **DUVIVIER**

Location: **Bruges-Belgium**

Industry: **Motors and Geared Motors Repair Shop**

Duvivier in Bruges is a repair shop company. They are in charge of repairing 12 small vertical mixers, for a chemical Company.

The bearings are sealed by lip seal. The M.T.B.R (Mid Time Between Repair) IS APPROXIMATELY 3 to 5 weeks. They asked the INPRO/SEAL local distributor to find a solution.

A standard VBXX VERTICAL DOWN Design, Ø 40 mm (1.575”) x 66 has been installed. After 7 weeks the mixer was back in the repair shop.

The Inpro Seal labyrinth was damaged, we observed:

- 1 - The Stator has turned in the Bearing cover.
- 2 - The Rotor is separate from the Stator.
- 3 - The Rotor has moved and turned on the shaft.

The Regional Manager proposed a special DESIGN to avoid any of these troubleshooting.

1 - Flange Mounting. 2 - Cap Lock Design 3 – Integral Locking Collar.

After 3 months of continuous running the end user has asked Duvivier to install the same Inpro Bearing Isolator on the other mixers.

[85.725]
 $\varnothing 3.375$
 D.B.C.

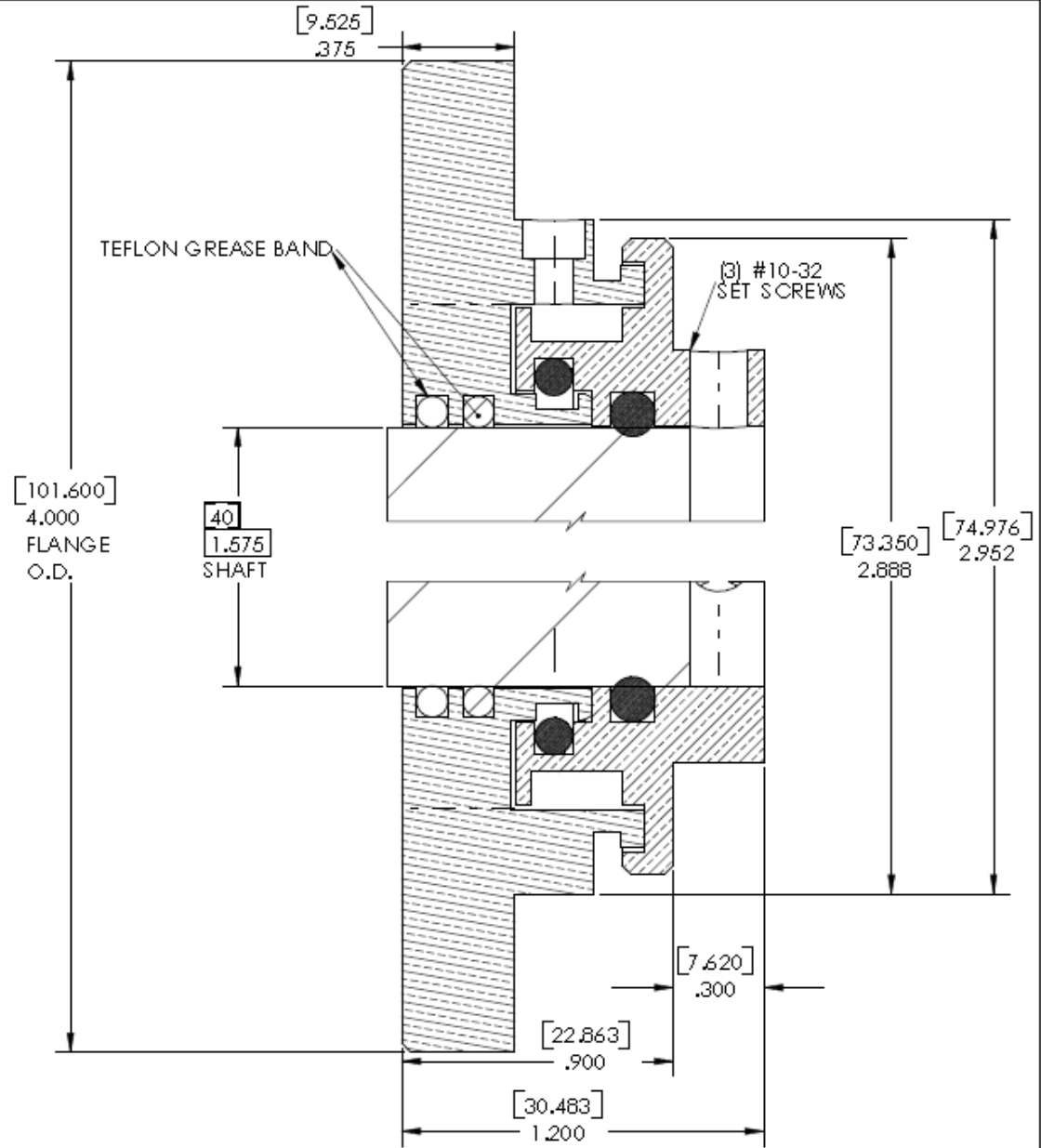
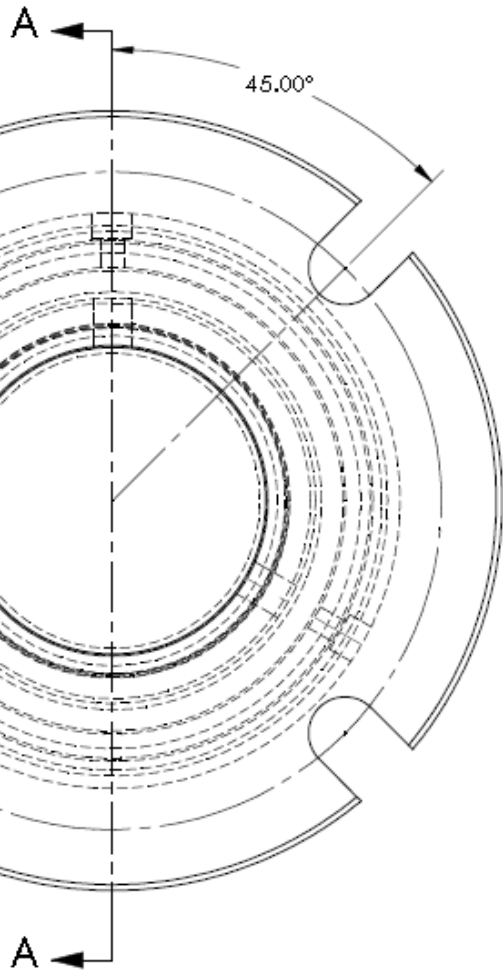

ALL DIMENSIONS ARE IN INCHES UNLESS OTHERWISE SPECIFIED.



THIS DRAWING INCLUDES THE DESIGN AND PRINCIPLES OF PROVISIONS DESCRIBED IN THE FIGURES OF THIS DRAWING WHICH ARE NOT TO BE REPRODUCED OR TRANSMITTED IN ANY FORM OR BY ANY MEANS, ELECTRONIC OR MECHANICAL, INCLUDING PHOTOCOPYING, RECORDING, OR BY ANY INFORMATION STORAGE AND RETRIEVAL SYSTEM, WITHOUT THE WRITTEN PERMISSION OF THE INTRONICS COMPANY. ACCEPTANCE OF THIS DRAWING SHALL BE CONSIDERED AS AN AGREEMENT TO THE ABOVE.

U.S. PATENTS
 7,090,405 6,082,585 5,174,555
 7,353,014 5,921,329 5,155,304
 6,439,253 5,285,441 5,134,049
 6,511,954 5,495,006 5,074,287
 6,254,409 5,275,020 5,089,461
 5,355,921 4,929,555
 5,221,095 4,552,550
 AND OTHERS PENDING

INPRO/SEAL BEARING ISOLATOR

DATE 06 MAR 08 DRAWN BY: TAF

TN13161