

CASE HISTORY REPORT



INPRO-SEAL-EUROPE : 2009-05

INPRO/SEAL

Company : **GDF-Suez – DK6** Location: **Dunkerque - FRANCE**

Industry: **PETROCHEMICAL** Application : **Cooling Tower Gearbox**

DK6 in Dunkerque is the first gas power station of GDF (Gas De France) in France. Yearly production is 480 MW, since 2005.

5 electric motors are driving 2 pumps, booster pump and boiler feed pump. Since start of the installation one side of the motor leaks oil.

DK6 decide to install special INPRO/SEAL labyrinth UNITARY FLANGE MOUNT DESIGN, specially made for Renk pillow block.

Up to date DK6 has decided to standardize on the other motors.



GDF SUEZ

dk6

TECHNICAL DESCRIPTION:

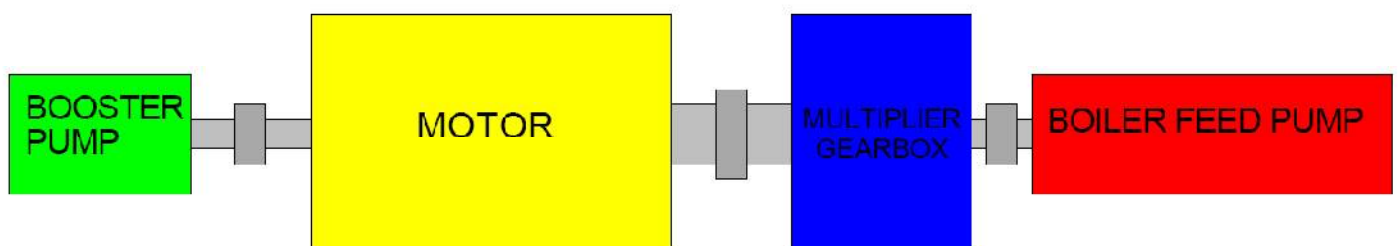

Inpro/Seal : **UNITARY FLANGE MOUNT SPLIT DESIGN TN15061**



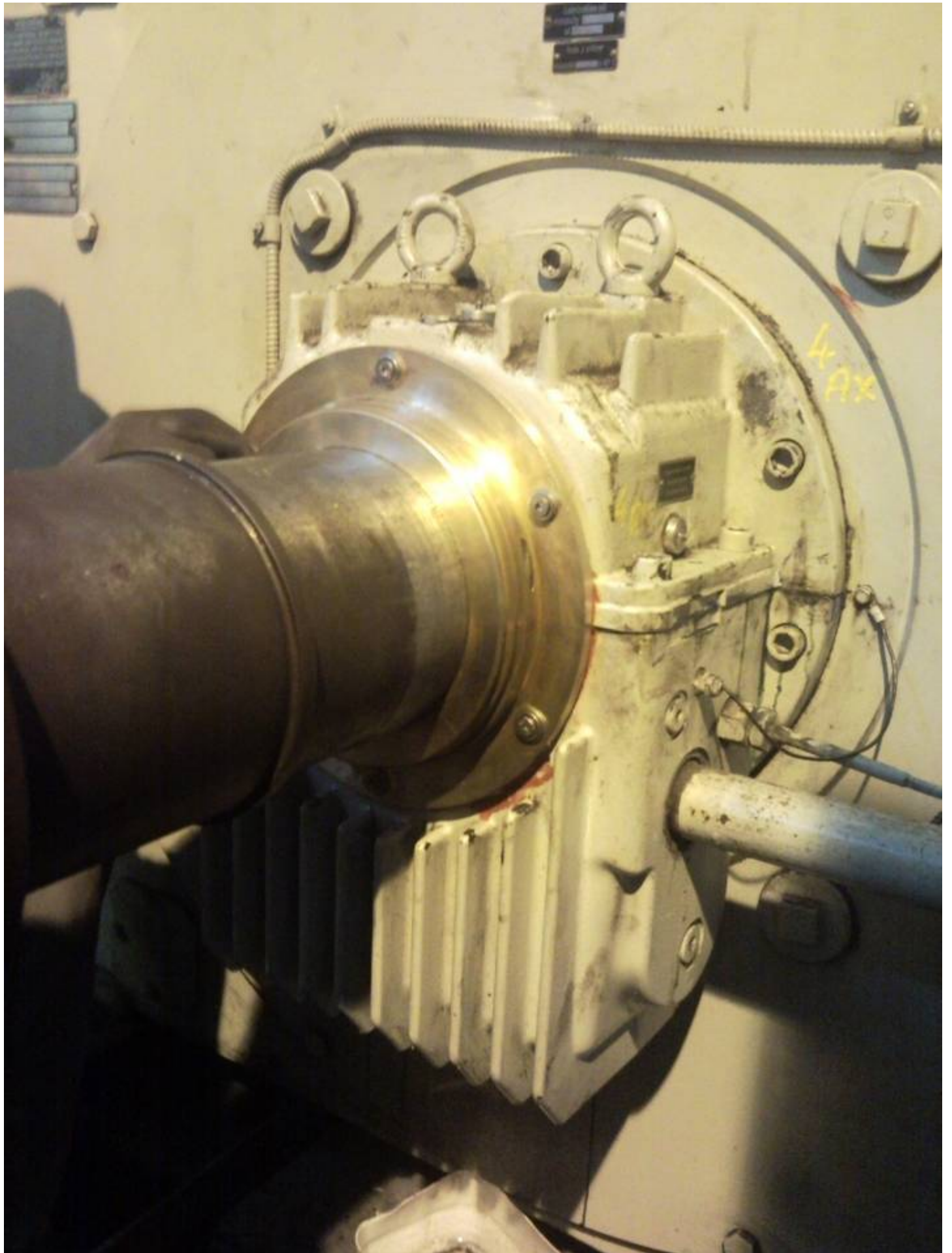

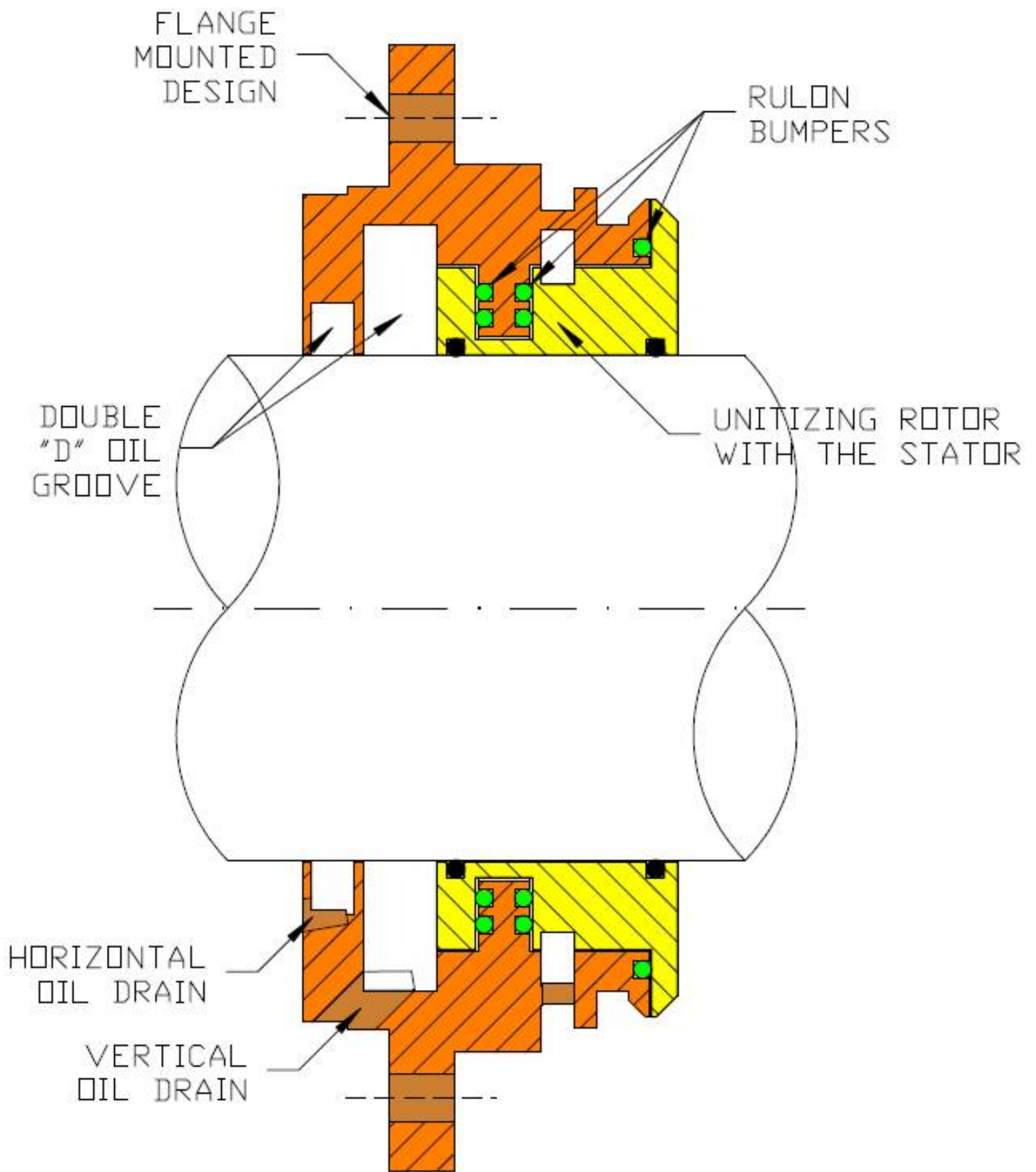

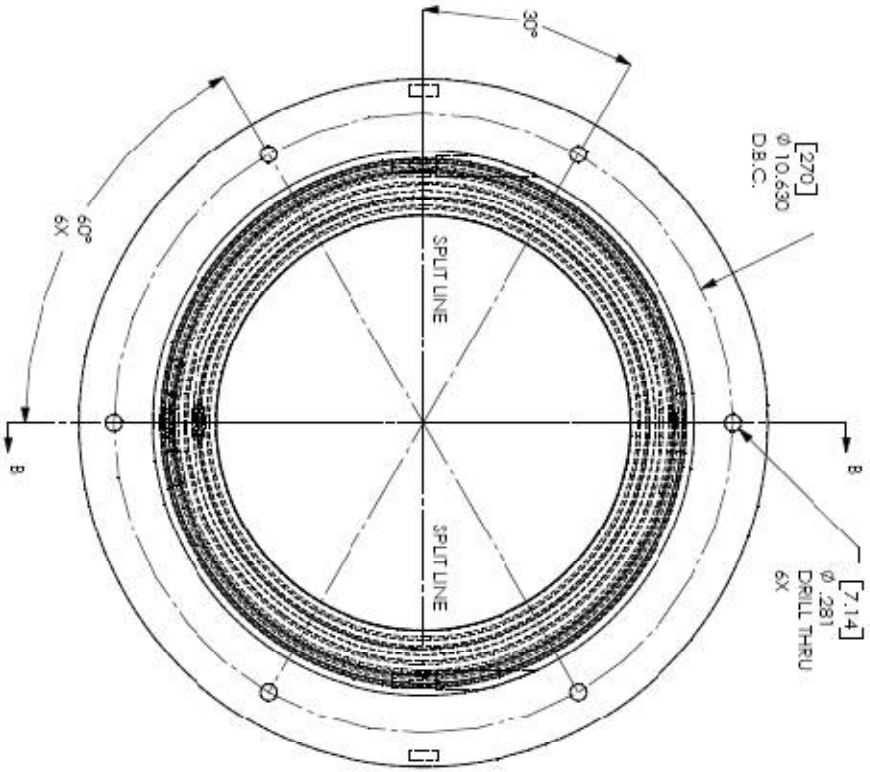

INPRO/SEAL P/N
8000-A-45248-5

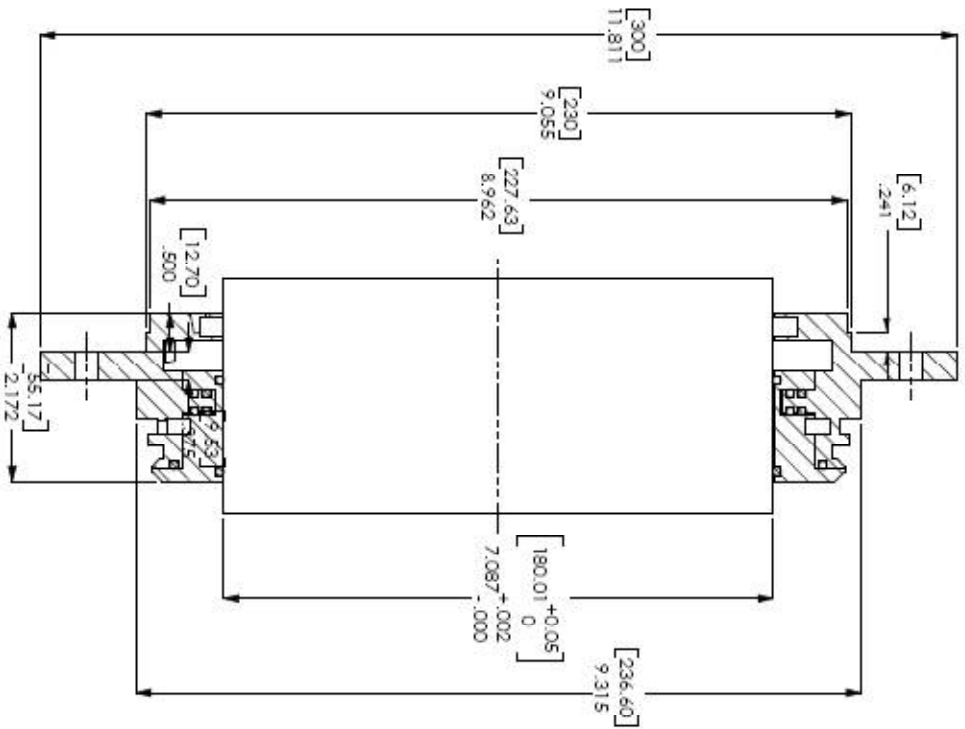

REVISED						THE PATENT RIGHTS IN THE INVENTION HEREIN ARE RESERVED FOR THE INVENTOR(S) AND/OR ASSIGNEE(S). ALL RIGHTS ARE RESERVED IN THE DESIGN, CONSTRUCTION, IDENTIFICATION, AND PERFORMANCE OF THE INVENTION. THE INVENTOR(S) AND/OR ASSIGNEE(S) SHALL BE RESPONSIBLE FOR OBTAINING NECESSARY PATENT RIGHTS AND PROTECTIVE COPIES OF THE PATENT DOCUMENTS AND OTHER DOCUMENTS FROM THE U.S. PATENT OFFICE, AND FOR FILING THE PATENT DOCUMENTS AND OTHER DOCUMENTS WITH THE U.S. PATENT OFFICE AND OTHERS RELEVANT TO THE INVENTION. THE INVENTOR(S) AND/OR ASSIGNEE(S) SHALL BE RESPONSIBLE FOR OBTAINING NECESSARY PATENT RIGHTS AND PROTECTIVE COPIES OF THE PATENT DOCUMENTS AND OTHER DOCUMENTS FROM THE U.S. PATENT OFFICE, AND FOR FILING THE PATENT DOCUMENTS AND OTHER DOCUMENTS WITH THE U.S. PATENT OFFICE AND OTHERS RELEVANT TO THE INVENTION.
U.S. PATENTS						
5,278,619	5,806,485					
5,283,813	4,386,883					
5,152,884	4,465,422					
5,193,855	4,375,925					
5,074,817	4,114,902					
TECO - WESTINGHOUSE						
RENK BEARING						
INPRO/SEAL						
DATE: 08 JUL 09						
DRAWN BY: CBE						
TN15061						

