

CASE HISTORY REPORT



INPRO-SEAL-EUROPE : 2011-05

INPRO/SEAL

Company : **EXXON**

Location: **Notre Dame de
Gravenchon - FRANCE**

Industry: **PETROCHEMICAL**

Application : **Process pump**

In 2009 EXXON petrochemical plant in Notre Dame de Gravenchon – France started to install INPRO/SEAL labyrinths On their process pumps.

In 2009, 60 pumps have been equipped. In 2010 47 pumps.

2009

17 x CODE 1000 for Durco pumps
6 x CODE 1007 ; 0.700" OAL with special insertion.
2 x CODE 1009 ; 0.900" OAL - STEPPED DESIGN
2 x CODE 1698 ; 0.625" OAL.
15 x CODE 1787
66 x CODE 1987

2009

5 x CODE 1000 for Durco pumps
6 x CODE 1007 ; 0.700" OAL with special insertion
3 x CODE 1009 ; 0.900" OAL with special insertion
4 x CODE 1698 ; 0.625" OAL.
2 x CODE 1601 ; 0.625" OAL with special insertion.
1 x CODE 1221 ; 0.550" OAL
17 x CODE 1787
37 x CODE 1987

The CODE 1787 & 1987 represent **89%*** of the selected labyrinths in
2009 and **77%*** in 2010.

*Without the CODE 1000 specially designed for Durco pumps.

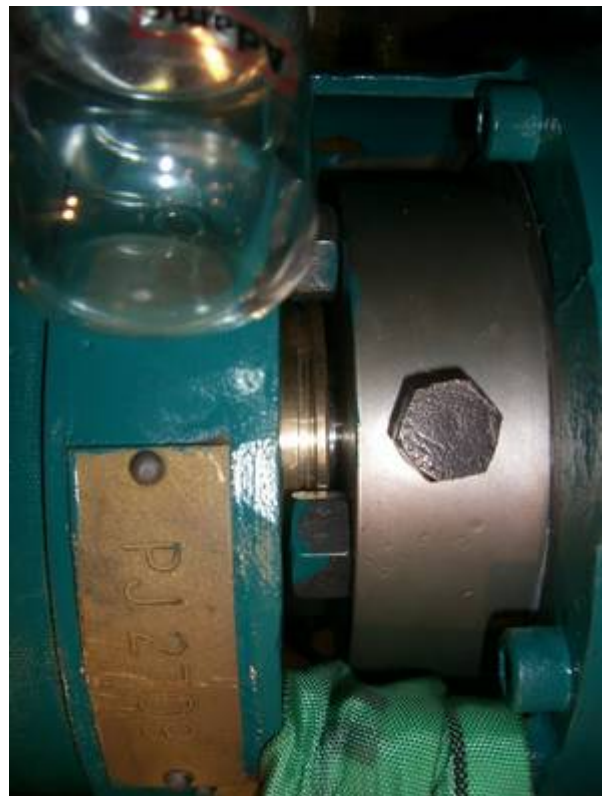



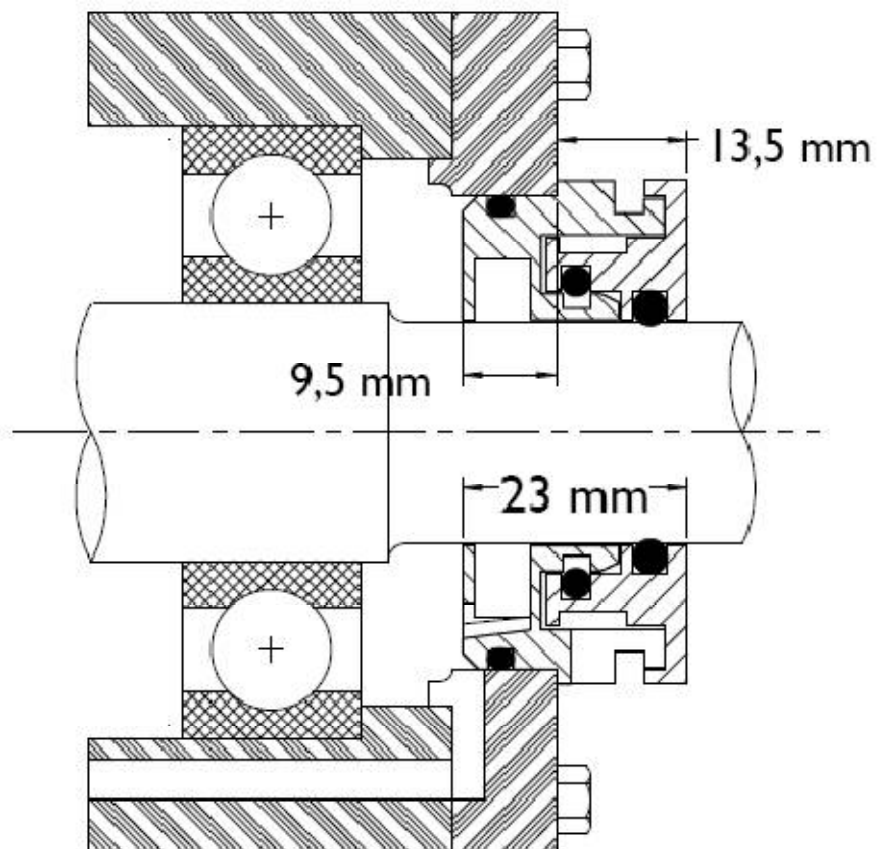

CODE 1987

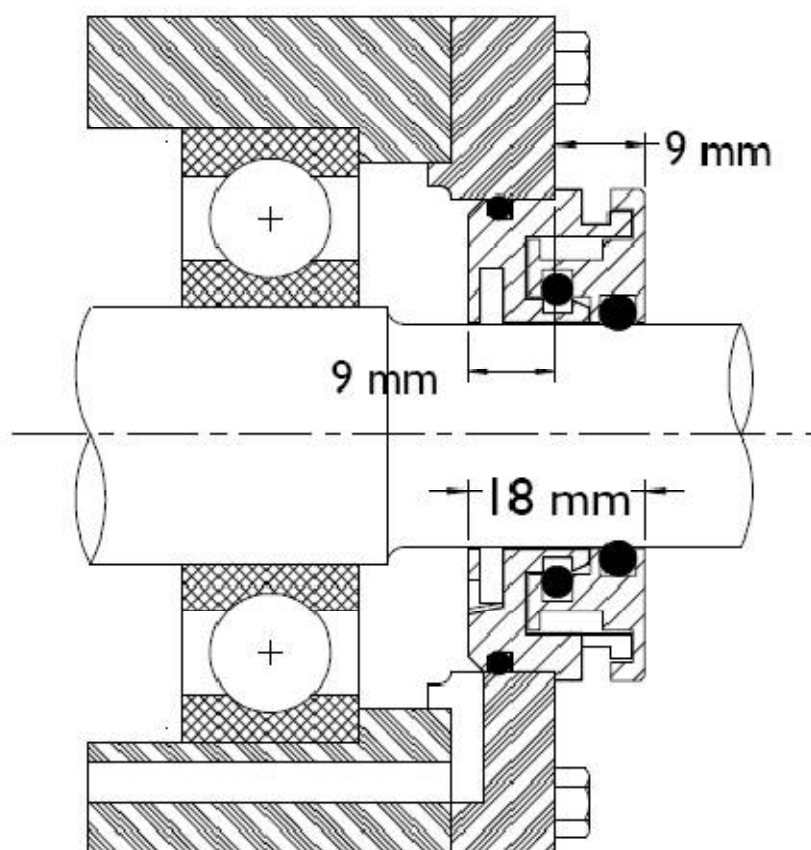

CODE 1787